

SAGITTARIUS

TAPS & SHOWERING

Construction	Brass, Polypropylene & ABS; Zinc alloy handle
Finishes	Chrome
Product Type	Contemporary
Water Pressure Tested Between Cartridge Fitting	Min. 0.2 bar, Max. 5.0 bar
Guarantee	35mm Ceramic disc valve Inlet: G3/4" BSP; Waste: G1-1/2" BSP
Additional Information	1 year against manufacturing faults (excluding serviceable parts) Center to center length : 86cm

LEVER BATH CENTRAFILL WITH BUILT IN ON/OFF VALVE

WBT/439/C

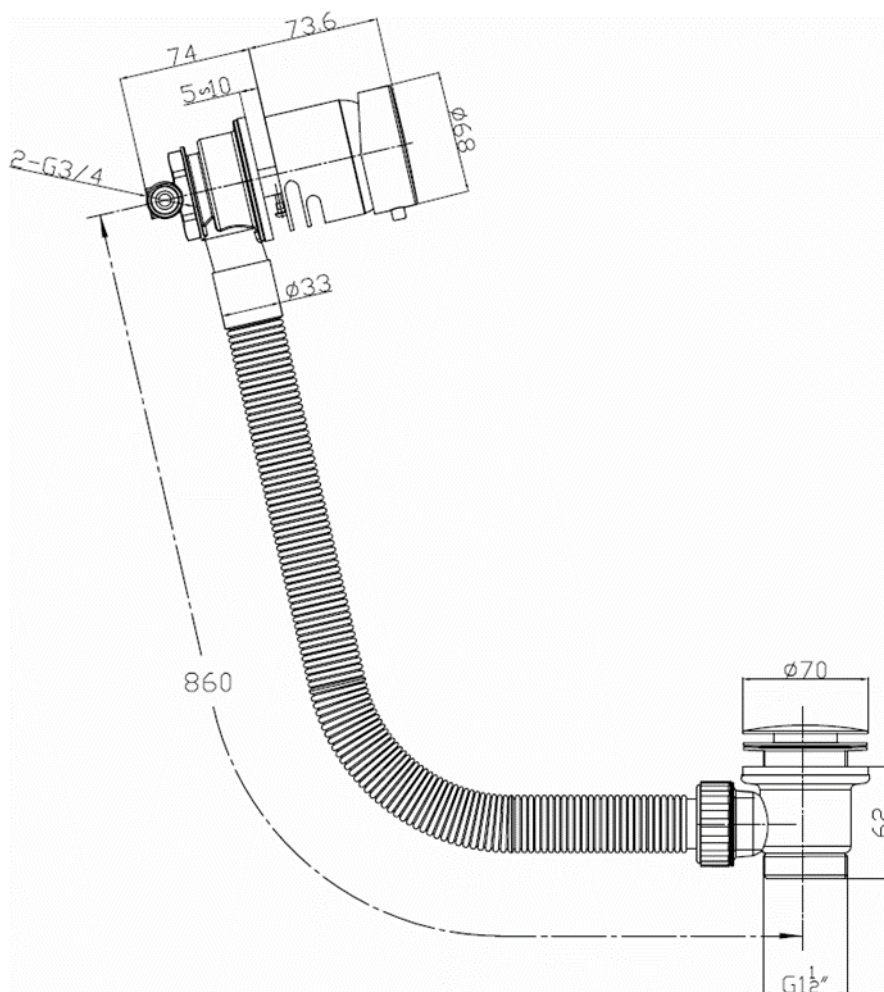

The information contained on this page was correct at the date of issue. Fitting dimensions are provided as a guide only. Some variation may occur due to manufacturing tolerances. We pursue a policy of continuing improvement in design and performance of our products and so reserve the right to change specifications without prior notice

FOR FURTHER ADVICE PLEASE CONTACT :-

SAGITTARIUS LTD UNIT 1 LOWER VICTORIA STREET—CHADDERTON—OLDHAM—OL9 9TU TEL:0616 6202029

EMAIL:TECHNICAL@SAGITTARIUSTAPS.CO.UK

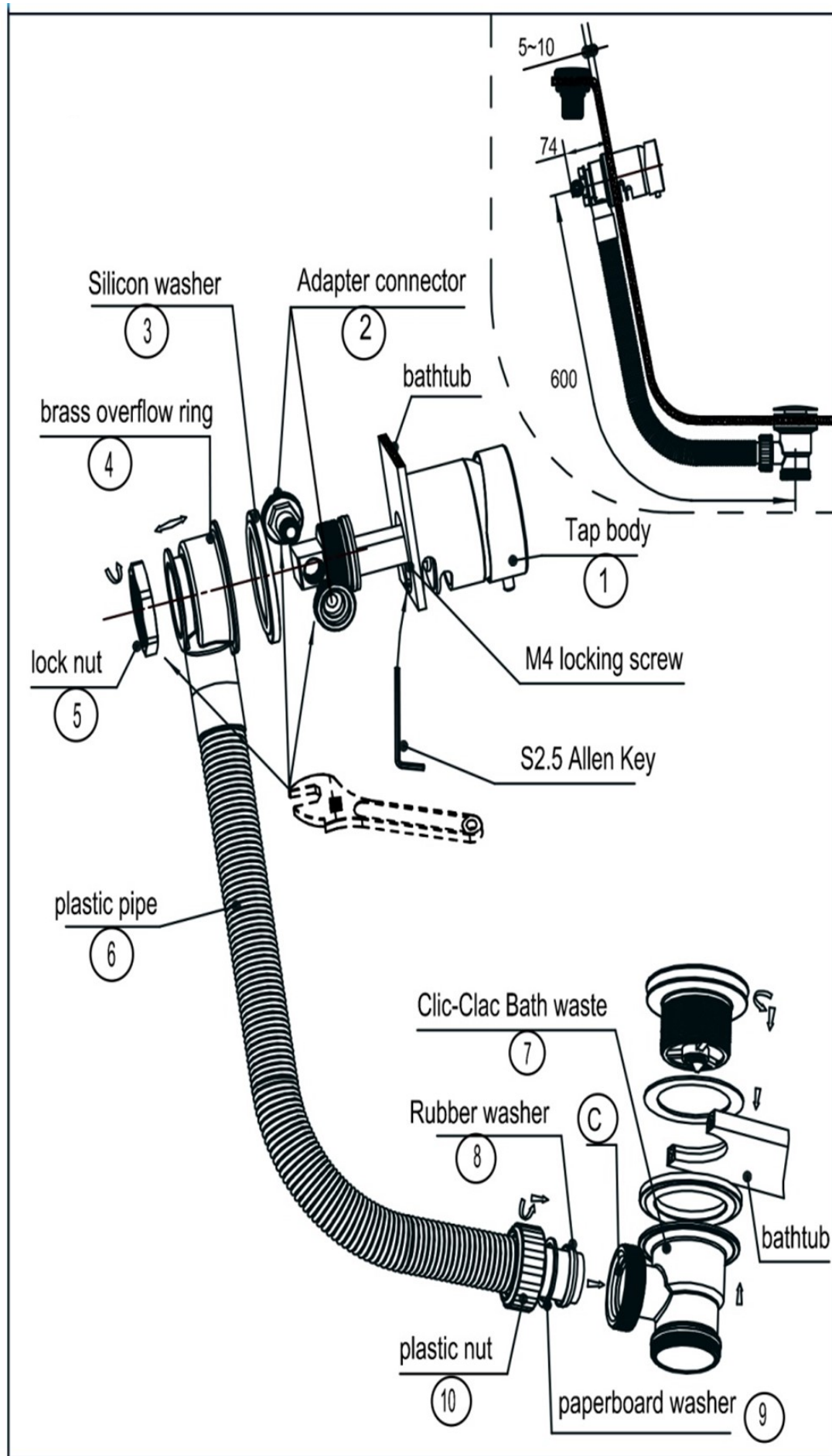

FOR FURTHER ADVICE PLEASE CONTACT :-

SAGITTARIUS LTD UNIT 1 LOWER VICTORIA STREET—CHADDERTON—OLDHAM—OL9 9TU TEL:0616 6202029

EMAIL:TECHNICAL@SAGITTARIUSTAPS.CO.UK