

SAGITTARIUS

TAPS & SHOWERING

Construction

Brass body, cover cap and clic-clac spring (HPb57-3), equivalent to EN CuZn39Pb3 / CW614N

**BASIN WASTER SOLID
SPRING LOADED**

WBS/427/C

Finishes

Chrome plated to BS EN 248

Product Type

Contemporary

Water Pressure Tested Between

Min. 0.2 bar,

Max. 5.0 bar

Fitting

Brass G1-1/4"

BSP Male

Thread (Outside

Diameter 40.5+/-

-0.25mm)

Guarantee

1 year against manufacturing faults (excluding serviceable parts)

Additional Information

Size: 80 mm tall;

Plastic lock nut

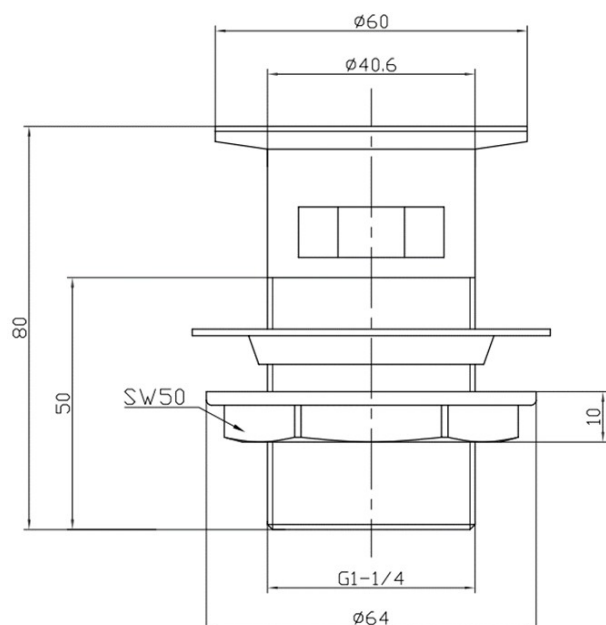

The information contained on this page was correct at the date of issue. Fitting dimensions are provided as a guide only. Some variation may occur due to manufacturing tolerances.

We pursue a policy of continuing improvement in design and performance of our products and so reserve the right to change specifications without prior notice

FOR FURTHER ADVICE PLEASE CONTACT :-

SAGITTARIUS LTD UNIT 1 LOWER VICTORIA STREET—CHADDERTON—OLDHAM—OL9 9TU TEL:0616 6202029

EMAIL:TECHNICAL@SAGITTARIUSTAPS.CO.UK

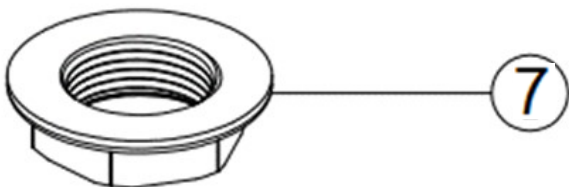
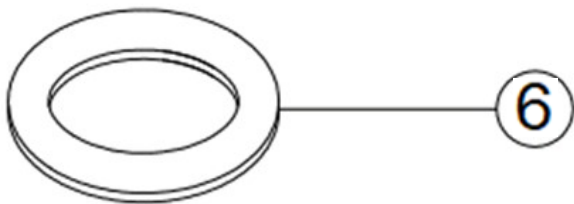
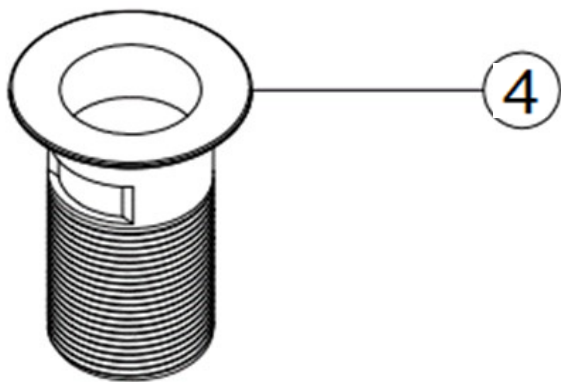
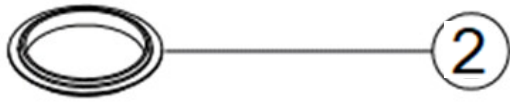

NO.	PART DESCRIPTION	QTY
1	BRASS COVER CAP	1
2	EPDM COVER CAP WASHER	1
3	BRASS CLIC-CLAC SPRING	1
4	BRASS WASTE BODY	1
5	SILICONE WASHER	1
6	SILICONE WASHER	1
7	PLASTIC LOCK NUT	1

FOR FURTHER ADVICE PLEASE CONTACT :-

SAGITTARIUS LTD UNIT 1 LOWER VICTORIA STREET—CHADDERTON—OLDHAM—OL9 9TU TEL:0616 6202029

EMAIL:TECHNICAL@SAGITTARIUSTAPS.CO.UK