

# SAGITTARIUS

## TAPS & SHOWERING

### SCALA TALL MONO BLOC

### BASIN MIXER

### SC/109

<b>Construction</b>	Brass Body, Zinc-alloy Handle
<b>Finishes</b>	Chrome plated to BS EN 248
<b>Product Type</b>	Contemporary
<b>Water Pressure</b>	Min. 0.2 bar, Max. 6.0 bar
<b>Tested Between</b>	
<b>Standards</b>	Complies with BS6920, BS EN200
<b>Cartridge</b>	35mm Ceramic disc cartridge
<b>Aerator</b>	Laminar stream straightener
<b>Fitting</b>	UK: M10 x 350mm G½" BSP Female Flexi Tails EU: M10 x 350mm G3/8" BSP Female Flexi Tails
<b>Guarantee</b>	10 years against manufacturing faults (excluding serviceable parts)
<b>Operating Water Pressure</b>	



The information contained on this page was correct at the date of issue. Fitting dimensions are provided as a guide only. Some variation may occur due to manufacturing tolerances. We pursue a policy of continuing improvement in design and performance of our products and so reserve the right to change specifications without prior notice

FOR FURTHER ADVICE PLEASE CONTACT :-

SAGITTARIUS LTD UNIT 1 LOWER VICTORIA STREET—CHADDERTON—OLDHAM—OL9 9TU TEL:0616 6202029

EMAIL:TECHNICAL@SAGITTARIUSTAPS.CO.UK

**Flow Rates** (Litres per minute)

System Pressure	0.1 Bar	0.2 Bar	0.3 Bar	0.5 Bar	1.0 Bar	1.5 Bar	2.0 Bar	3.0 Bar	4.0 Bar	5.0 Bar
	-	4.9	-	7.0	9.6	-	13.4	16.4	-	-

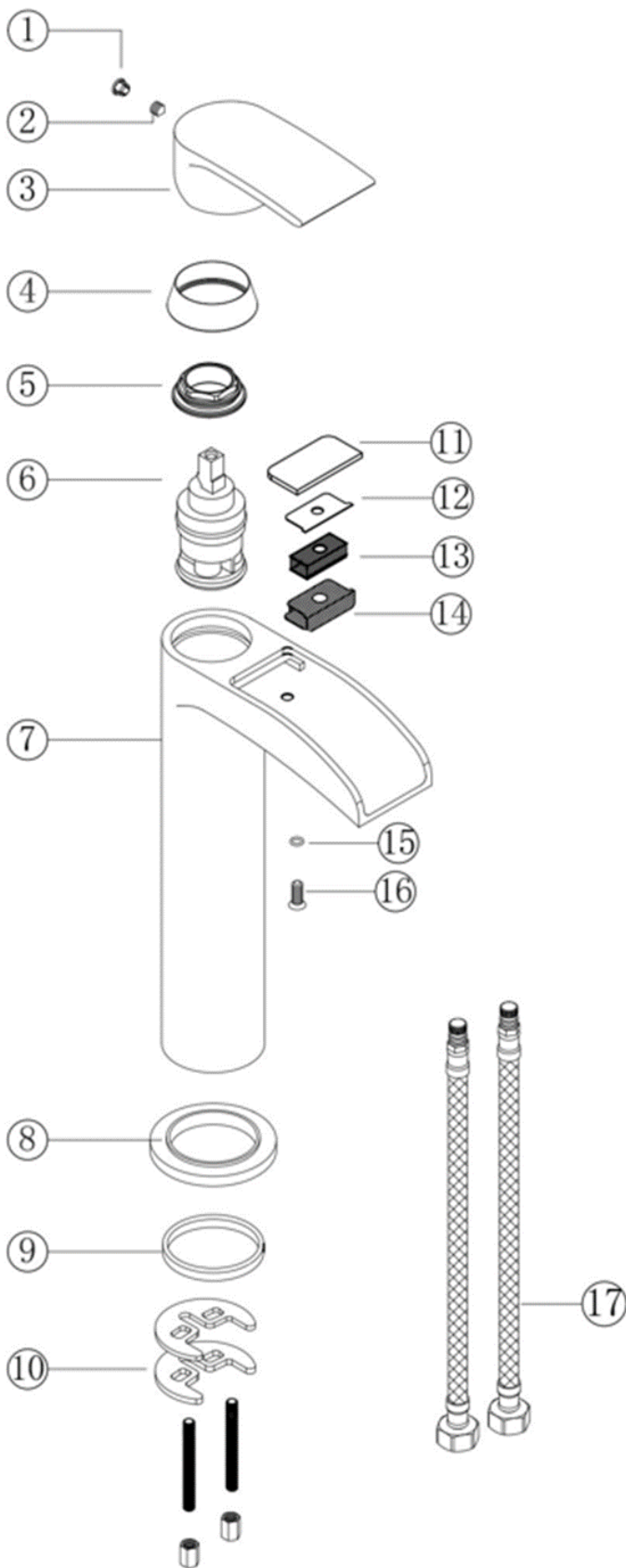

NO.	Part Name
1	Cover Cap
2	Screw
3	Handle
4	Ornament Cover
5	Retainer Nut
6	Cartridge
7	Body
8	Base
9	Washer
10	Fixing Pack
11	Filter Holder
12	Washer
13	Filter Netting (thin)
14	Filter Netting
15	O-ring
16	Screw
17	Stainless Hose