

SAGITTARIUS

TAPS & SHOWERING

RAVENNA WALL MOUNTED BASIN MIXER BLACK RA/170/B

Construction	Brass Body, Zinc-alloy Handle; Stainless steel Face plate
Finishes	Matt Black
Product Type	Contemporary
Water Pressure Tested Between	Min. 0.2 bar, Max. 6.0 bar
Standards	Complies with BS5412, BS EN200
Cartridge	35mm WANHAI Ceramic disc cartridge
Aerator	M24*1 Spout aerator
Fitting	Two G1/2" x G1/2" BSP Flexible inlet connection hoses supplied (hot and cold)
Guarantee	5 years against manufacturing faults (excluding serviceable parts)

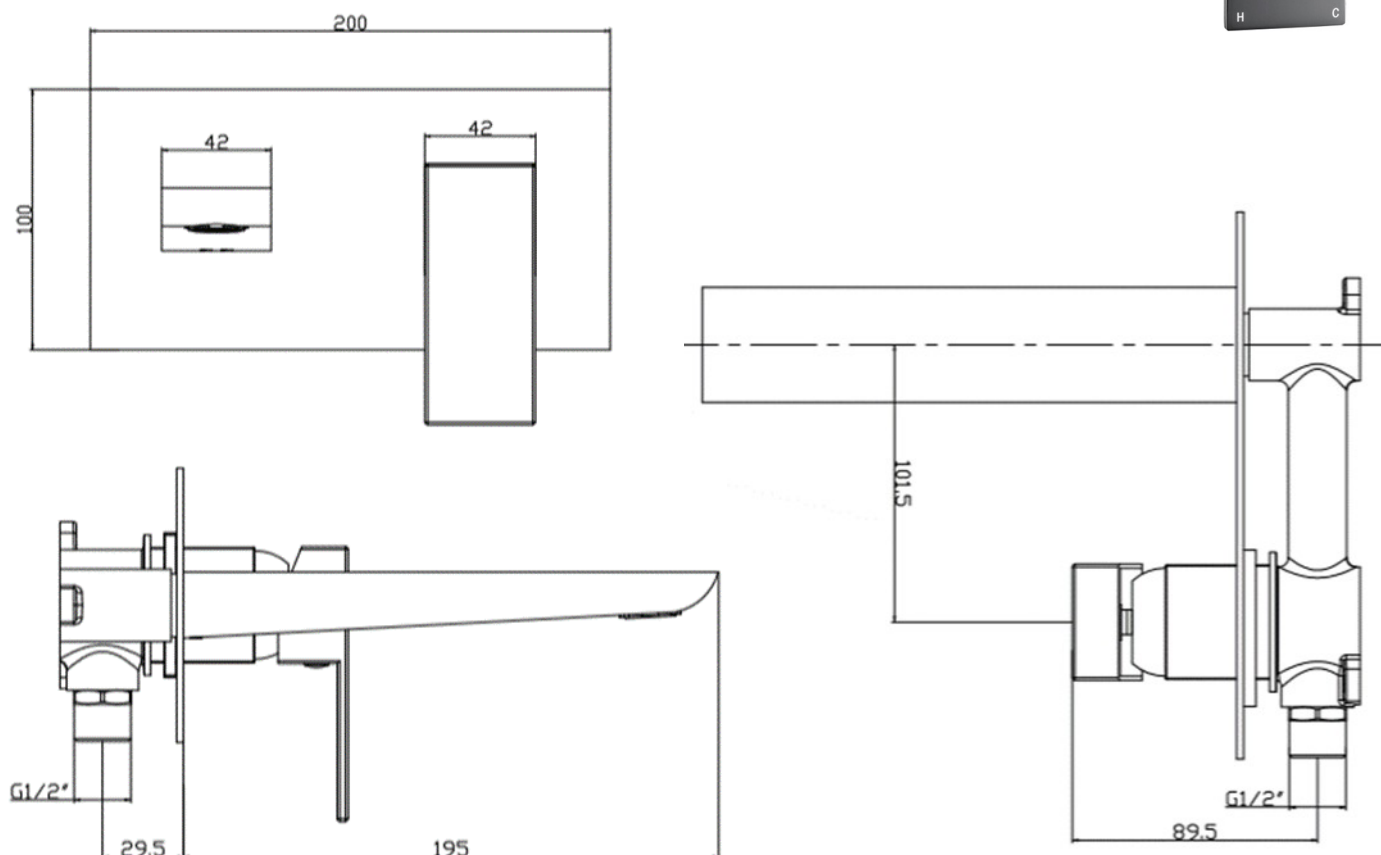

The information contained on this page was correct at the date of issue. Fitting dimensions are provided as a guide only. Some variation may occur due to manufacturing tolerances. We pursue a policy of continuing improvement in design and performance of our products and so reserve the right to change specifications without prior notice

FOR FURTHER ADVICE PLEASE CONTACT :-

SAGITTARIUS LTD UNIT 1 LOWER VICTORIA STREET—CHADDERTON—OLDHAM—OL9 9TU TEL:0616 6202029

EMAIL:TECHNICAL@SAGITTARIUSTAPS.CO.UK

Flow Rates (Litres per minute)

System Pressure	0.1 Bar	0.2 Bar	0.3 Bar	0.5 Bar	1.0 Bar	1.5 Bar	2.0 Bar	3.0 Bar	4.0 Bar	5.0 Bar
	-	4.0	-	5.8	7.7	9.5	11.0	13.6	-	-

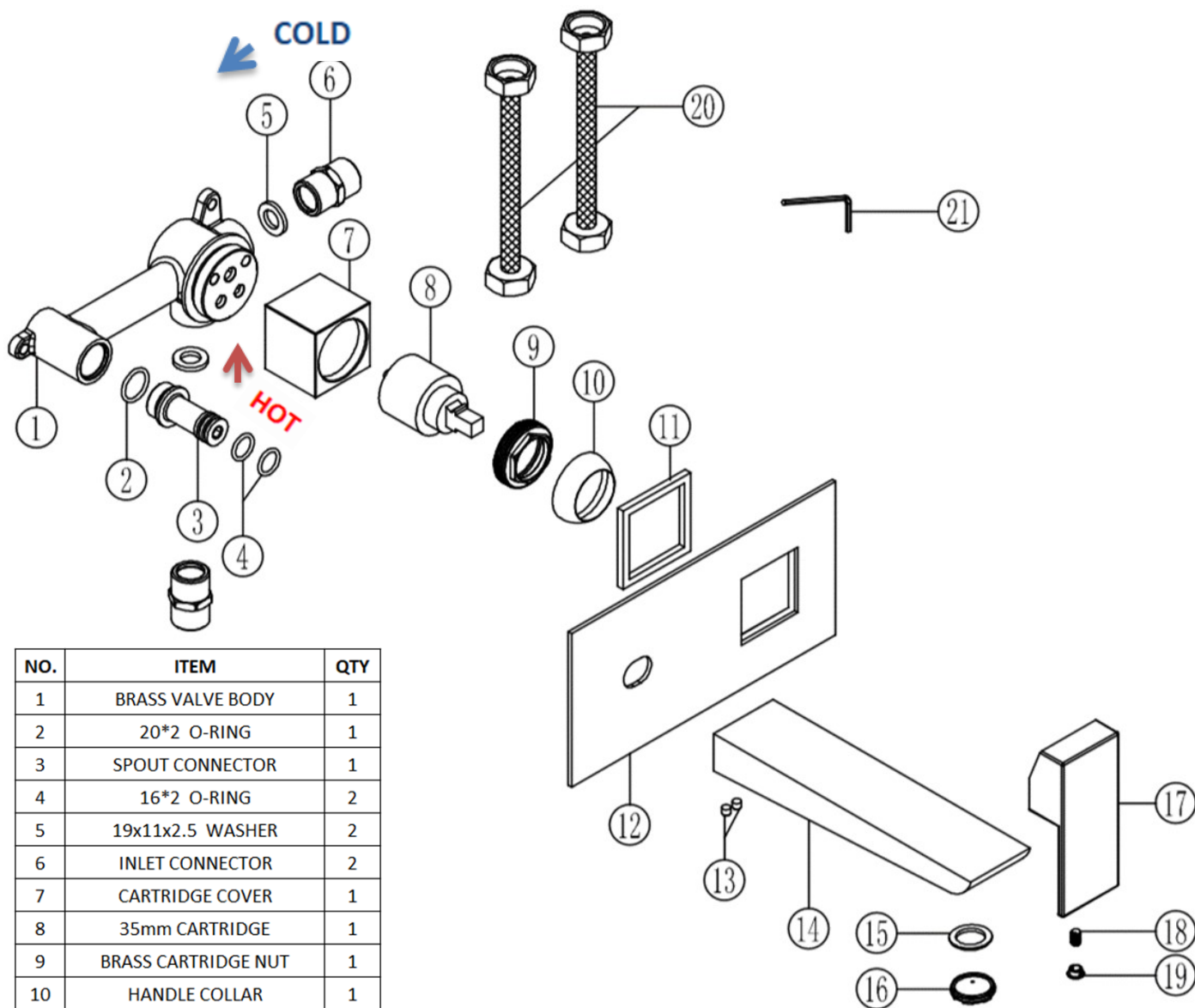

NO.	ITEM	QTY
1	BRASS VALVE BODY	1
2	20*2 O-RING	1
3	SPOUT CONNECTOR	1
4	16*2 O-RING	2
5	19x11x2.5 WASHER	2
6	INLET CONNECTOR	2
7	CARTRIDGE COVER	1
8	35mm CARTRIDGE	1
9	BRASS CARTRIDGE NUT	1
10	HANDLE COLLAR	1
11	51x42x4 WASHER	1
12	SS FACE PLATE	1
13	5*4 GRUB SCREW	2
14	BRASS SPOUT	1
15	23x16x3 AERATOR WASHER	1
16	M24*1 AERATOR	1
17	HANDLE	1
18	5*8 GRUB SCREW	1
19	CHROME COVER CAP	1
20	G1/2" 150mm FLEXI-TAILS	2
21	2.5 ALLEN KEY	1

FOR FURTHER ADVICE PLEASE CONTACT :-
 SAGITTARIUS LTD UNIT 1 LOWER VICTORIA STREET—CHADDERTON—OLDHAM—OL9 9TU TEL:0616 6202029
 EMAIL:TECHNICAL@SAGITTARIUSTAPS.CO.UK