

# SAGITTARIUS

## TAPS & SHOWERING

<b>Construction</b>	Brass Body CuZn40Pb2, EN CW617N (equivalent to BS CZ122) Zinc alloy Handle
<b>Finishes</b>	Chrome plated to BS EN 248
<b>Product Type</b>	Contemporary
<b>Water Pressure</b>	Min. 0.2 bar, Max. 6.0 bar
<b>Plumbing Systems</b>	Suitable for all plumbing systems
<b>Standards</b>	Complies with BS5412, BS EN200
<b>Certification</b>	UK stock is not WRAS approved (WRAS version available for pre order)
<b>Cartridge</b>	1/4 Turn 3/4" Ceramic Disc Valves
<b>Net Weight</b>	2020g
<b>Aerator</b>	Laminar spout
<b>Fitting</b>	Brass 3/4" BSP Tails
<b>Packaging</b>	49.5 x 41.5 x 33cm / carton (8 boxes / carton)
<b>Guarantee</b>	10 years against manufacturing faults (excluding serviceable parts).

### NAPLES BATH FILLER

### CHROME

### NA/104/C

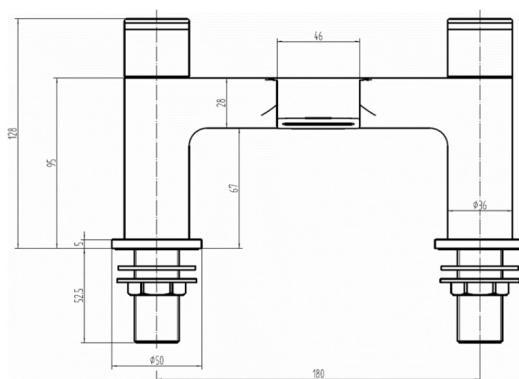
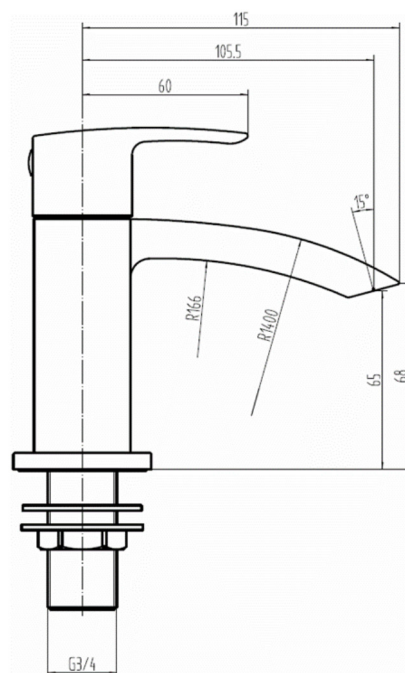

### Flow Rates (Litres per minute)

System Pressure	0.1 Bar	0.2 Bar	0.3 Bar	0.5 Bar	1.0 Bar	1.5 Bar	2.0 Bar	3.0 Bar	4.0 Bar	5.0 Bar
NA/104/C	-	10.0	-	16.4	22.4	24.8	26.7	28.3	-	-

The information contained on this page was correct at the date of issue. Fitting dimensions are provided as a guide only. Some variation may occur due to manufacturing tolerances. We pursue a policy of continuing improvement in design and performance of our products and so reserve the right to change specifications without prior notice

FOR FURTHER ADVICE PLEASE CONTACT :-

SAGITTARIUS LTD UNIT 1 LOWER VICTORIA STREET—CHADDERTON—OLDHAM—OL9 9TU TEL:0616 6202029

EMAIL:TECHNICAL@SAGITTARIUSTAPS.CO.UK

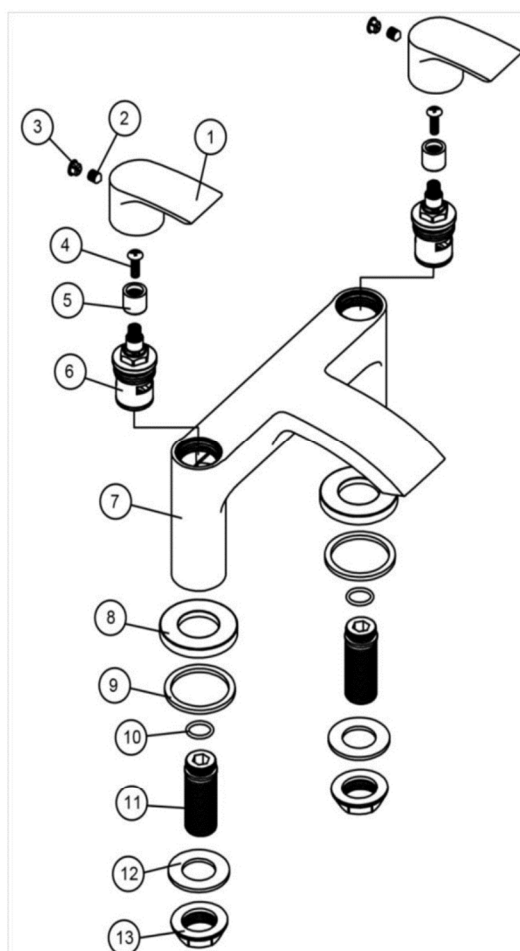

NO.	ITEM CODE	DESCRIPTION	QTY
1	SB03-01	HANDLES	2
2	SB03-02	M5*6 SCREW	2
3	SB03-03	HANDLE COVER	2
4	SB03-04	M4*9 SCREW	2
5	SB03-05	PLASTIC CORE	2
6	SB03-06	G3/4" QUARTER-TURN CARTRIDGE	2
7	SB03-07	TAP BODY	1
8	SB03-08	BASE PLATE	2
9	SB03-09	46*38*2.5 WASHER	2
10	SB03-10	24*2.4 "O" RING	2
11	SB03-11	G3/4" INLET	2
12	SB03-12	G3/4" WASHER	2
13	SB03-13	BACK NUT	2

## Bath Filler

The information contained on this page was correct at the date of issue. Fitting dimensions are provided as a guide only. Some variation may occur due to manufacturing tolerances. We pursue a policy of continuing improvement in design and performance of our products and so reserve the right to change specifications without prior notice

FOR FURTHER ADVICE PLEASE CONTACT :-

SAGITTARIUS LTD UNIT 1 LOWER VICTORIA STREET—CHADDERTON—OLDHAM—OL9 9TU TEL:0616 6202029

EMAIL:TECHNICAL@SAGITTARIUSTAPS.CO.UK