

SAGITTARIUS

TAPS & SHOWERING

Construction	Brass Body (H59-1), equivalent to BS
Finishes	Chrome plated to BS EN 248
Product Type	Contemporary
Water Pressure Tested Between Fitting	Min. 0.2 bar, Max. 6.0 bar
Guarantee	1 year against manufacturing faults

ROUND WALL MOUNTED SHOWER KIT WITH OUTLET BRACKET CHROME

HND/656/C

Additional Information	<ol style="list-style-type: none">1. Chrome , ABS single mode shower handset2. Chrome , Stainless steel shower hose , 1.5m , G1/2" BSP3. Intergrated Brass wall elbow outlet and handset holder
-------------------------------	---------------------------------------------------------------------------------------------------------------------------------------------------------------------------------------------------------------------------------

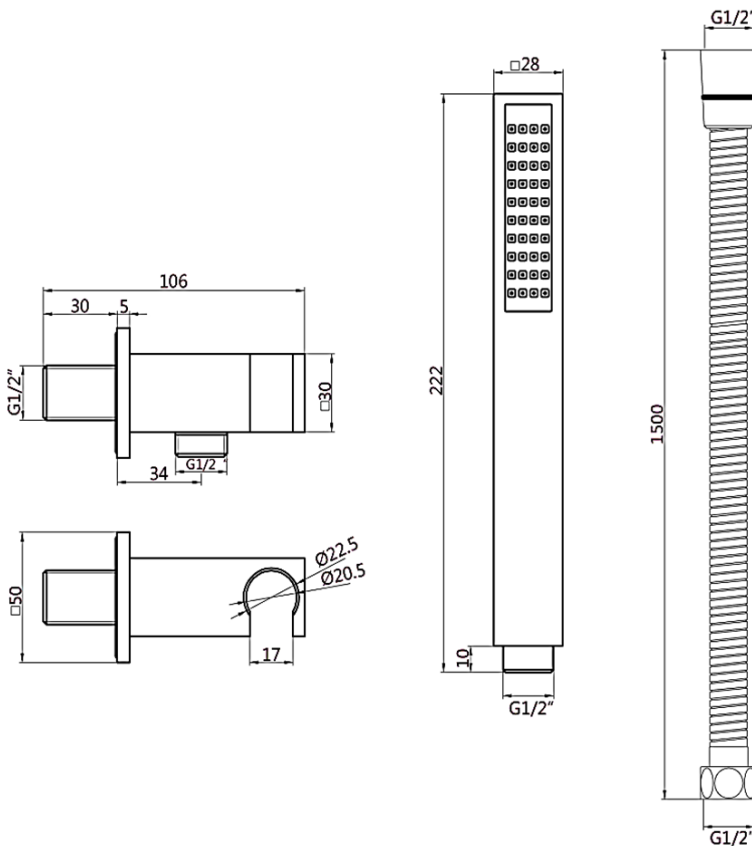

The information contained on this page was correct at the date of issue. Fitting dimensions are provided as a guide only. Some variation may occur due to manufacturing tolerances. We pursue a policy of continuing improvement in design and performance of our products and so reserve the right to change specifications without prior notice

FOR FURTHER ADVICE PLEASE CONTACT :-

SAGITTARIUS LTD UNIT 1 LOWER VICTORIA STREET—CHADDERTON—OLDHAM—OL9 9TU TEL:0616 6202029

EMAIL:TECHNICAL@SAGITTARIUSTAPS.CO.UK

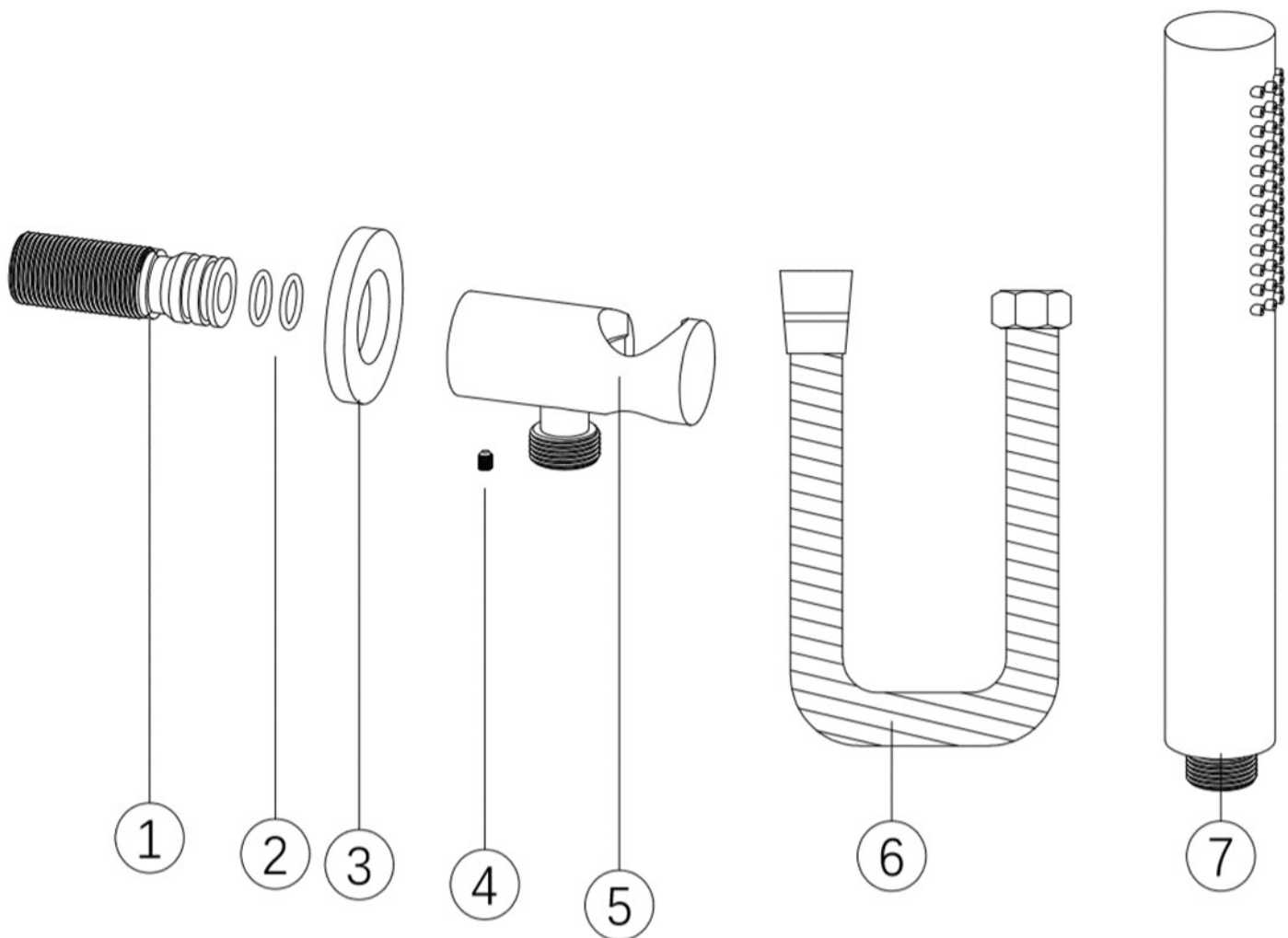

NO.	PARTS DESCRIPTION	QTY
1	BRASS INLET CONNECTOR	1
2	Ø20*2 NBR O-RING	2
3	BRASS BASE PLATE	1
4	M4*5 S/STEEL GRUB SCREW	1
5	BRASS OUTLET & HANDSET HOLDER	1
6	1.5M S/STEEL SHOWER HOSE	1
7	ABS SHOWER HANDSET	1

FOR FURTHER ADVICE PLEASE CONTACT :-

SAGITTARIUS LTD UNIT 1 LOWER VICTORIA STREET—CHADDERTON—OLDHAM—OL9 9TU TEL:0616 6202029

EMAIL:TECHNICAL@SAGITTARIUSTAPS.CO.UK