

SAGITTARIUS

TAPS & SHOWERING

| | |
|--------------------------------------|---|
| Construction | Brass |
| Finishes | Brushed Brass |
| Product Type | Contemporary |
| Water Pressure Tested Between | Min. 0.2 bar, Max. 5.0 bar |
| Fitting | G 1/2" BSP |
| Guarantee | 5 year against manufacturing faults (excluding serviceable parts) |
| Additional Information | 1. Brass handset 2. 1.5m PVC shower hose 3. Intergrated wall elbow outlet |

**ROUND WALL MOUNTED
SHOWER KIT C/W OUTLET
BRACKET BRUSHED BRASS
HND/656/BB**

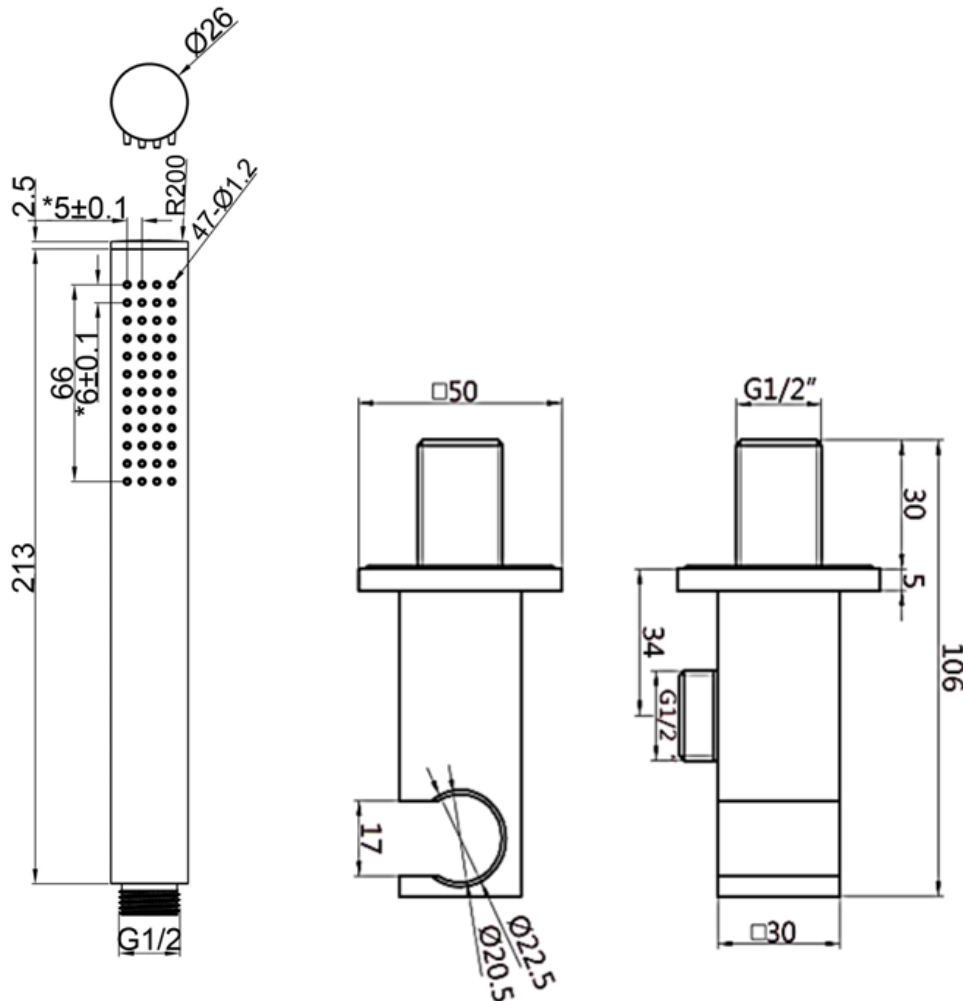

The information contained on this page was correct at the date of issue. Fitting dimensions are provided as a guide only. Some variation may occur due to manufacturing tolerances. We pursue a policy of continuing improvement in design and performance of our products and so reserve the right to change specifications without prior notice

FOR FURTHER ADVICE PLEASE CONTACT :-

SAGITTARIUS LTD UNIT 1 LOWER VICTORIA STREET—CHADDERTON—OLDHAM—OL9 9TU TEL:0616 6202029

EMAIL:TECHNICAL@SAGITTARIUSTAPS.CO.UK

| NO. | PARTS DESCRIPTION | QTY |
|-----|-------------------------------|-----|
| 1 | BRASS INLET CONNECTOR | 1 |
| 2 | O-RING | 2 |
| 3 | BRASS BASE PLATE | 1 |
| 4 | GRUB SCREW | 1 |
| 5 | BRASS OUTLET & HANDSET HOLDER | 1 |
| 6 | PVC SHOWER HOSE | 1 |
| 7 | SHOWER HANDSET | 1 |

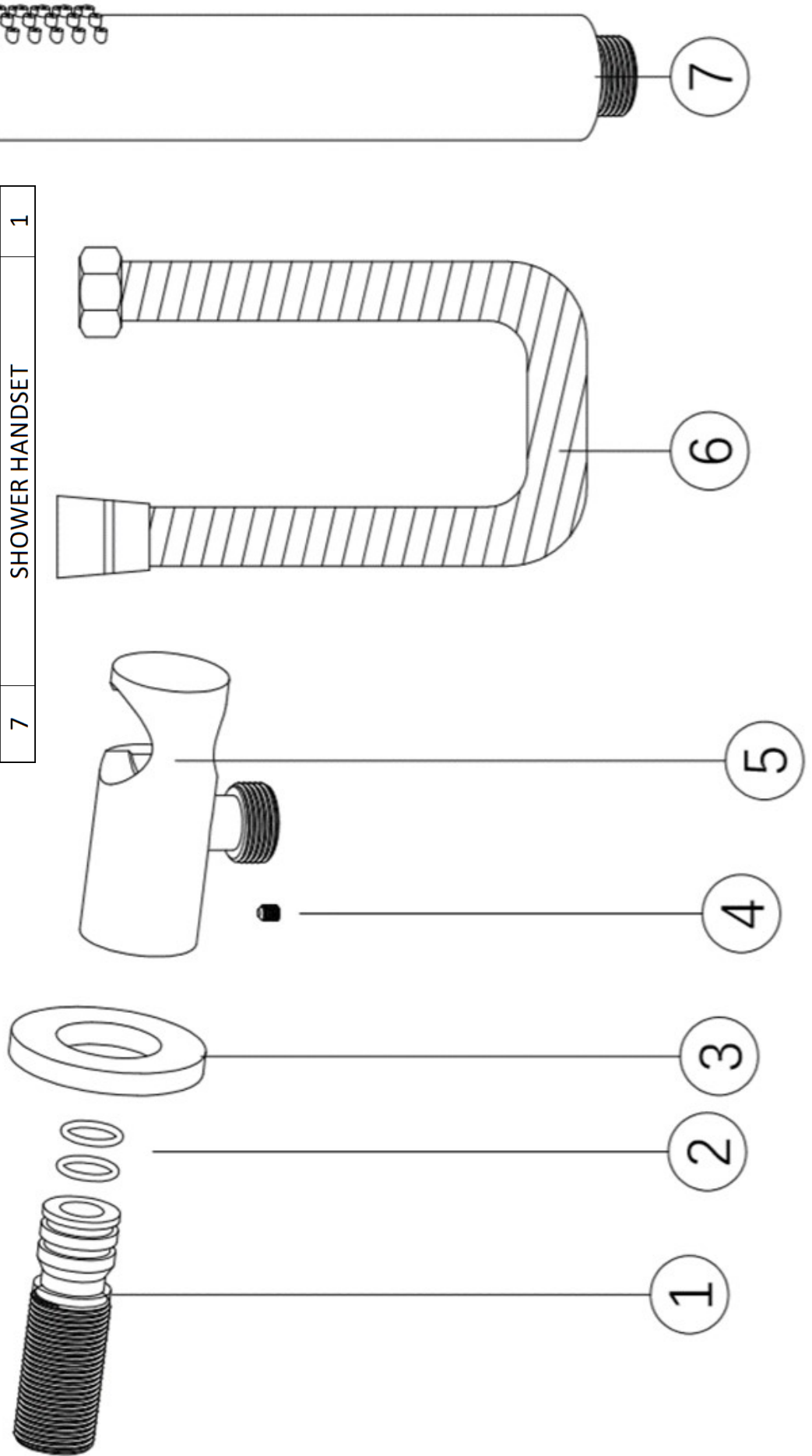

FOR FURTHER ADVICE PLEASE CONTACT :-

SAGITTARIUS LTD UNIT 1 LOWER VICTORIA STREET—CHADDERTON—OLDHAM—OL9 9TU TEL:0616 6202029

EMAIL:TECHNICAL@SAGITTARIUSTAPS.CO.UK