

# SAGITTARIUS

## TAPS & SHOWERING

|                               |   |
|-------------------------------|---|
| <b>Construction</b>           | Brass Body CuZn40Pb2, EN CW617N (equivalent to BS CZ122); zinc alloy handle |
| <b>Finishes</b>               | Chrome plated to BS EN 248  |
| <b>Product Type</b>           | Contemporary  |
| <b>Water Pressure</b>         | Min. 1.0 bar, Max. 6.0 bar  |
| <b>Plumbing Systems</b>       | Suitable for all plumbing systems   |
| <b>Standards</b>              | Complies with BS5412, BS EN200  |
| <b>Certification</b>          | -   |
| <b>Aerator</b>                | Aerator spout   |
| <b>Cartridge</b>              | 40mm Ceramic disc cartridge   |
| <b>Fitting</b>                | Brass 3/4" BSP  |
| <b>Packaging</b>              | 94.5 x 34.5 x 40cm / carton (4 boxes / carton)                              |
| <b>Guarantee</b>              | 10 years against manufacturing faults (excluding serviceable parts).        |
| <b>Additional Information</b> | Supplied ABS handset & 1.5m SS304 shower hose                               |

ERGO FLOOR MOUNTED

BSM CHROME

EL/214/C

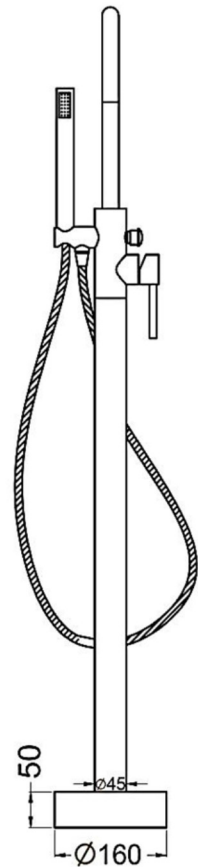
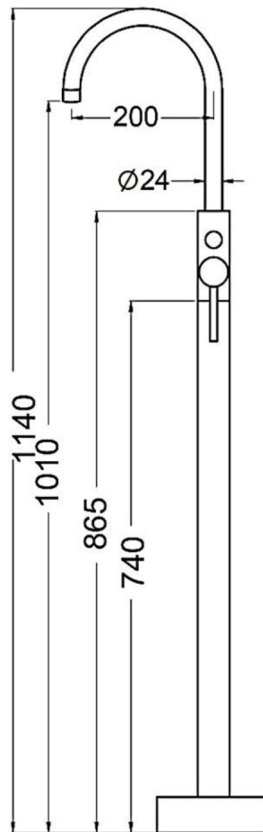

### Flow Rates (Litres per minute)

| System Pressure | 0.1 Bar | 0.2 Bar | 0.3 Bar | 0.5 Bar | 1.0 Bar | 1.5 Bar | 2.0 Bar | 3.0 Bar | 4.0 Bar | 5.0 Bar |
|-----------------|---------|---------|---------|---------|---------|---------|---------|---------|---------|---------|
| EL/214/C        | 2.7     | 3.2     | 3.6     | 4.3     | 6.0     | 7.5     | 8.4     | 10.2    | 11.7    | 13.1    |

The information contained on this page was correct at the date of issue. Fitting dimensions are provided as a guide only. Some variation may occur due to manufacturing tolerances. We pursue a policy of continuing improvement in design and performance of our products and so reserve the right to change specifications without prior notice

FOR FURTHER ADVICE PLEASE CONTACT :-

SAGITTARIUS LTD UNIT 1 LOWER VICTORIA STREET—CHADDERTON—OLDHAM—OL9 9TU TEL:0616 6202029

EMAIL:TECHNICAL@SAGITTARIUSTAPS.CO.UK

EXPLODED PARTS DRAWING EL/214/C

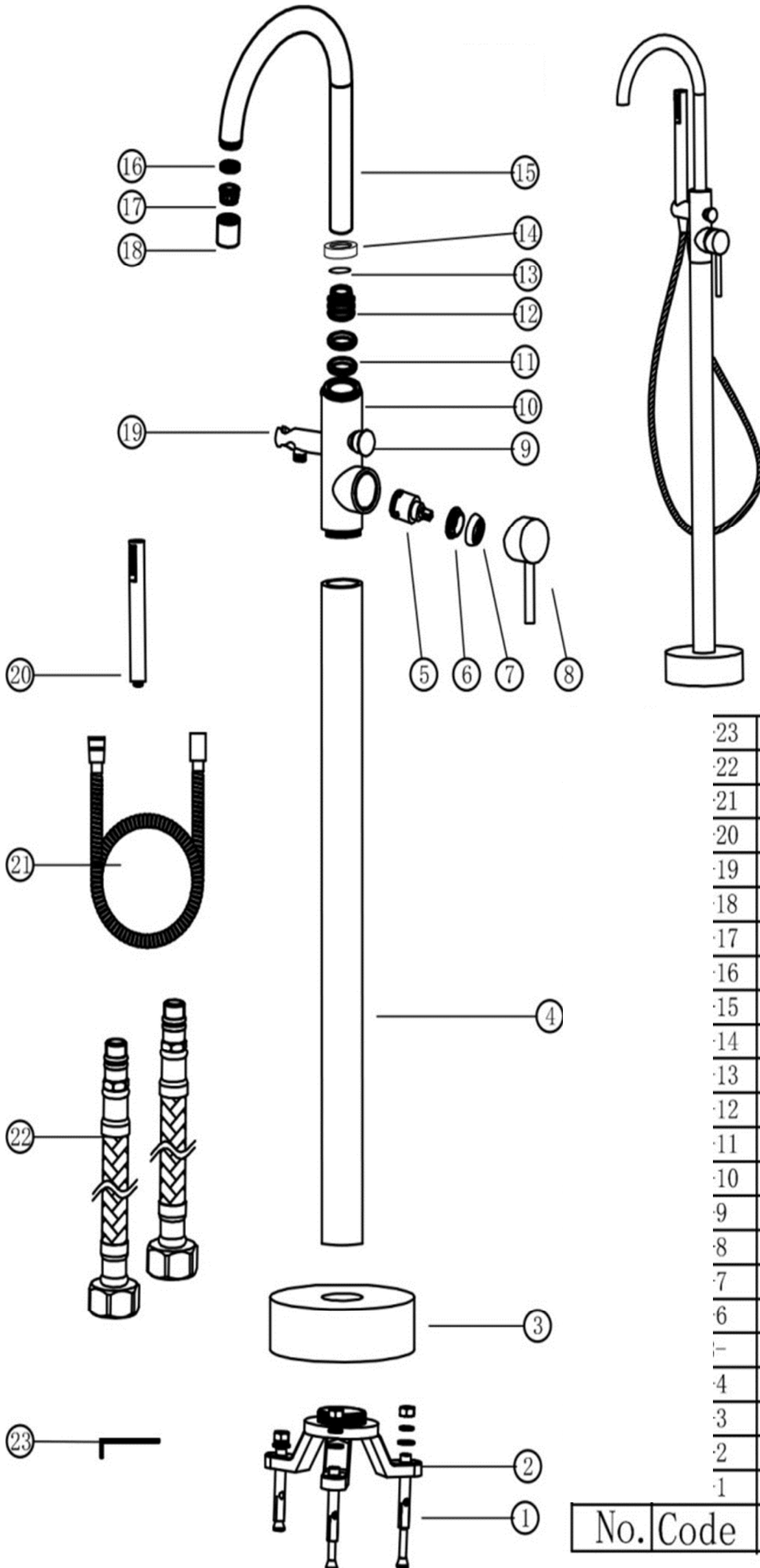

|     |                 |   |
|-----|-----------------|---|
| ·23 | Hex key         | 1 |
| ·22 | Flexi tails     | 2 |
| ·21 | Hose            | 1 |
| ·20 | Handset         | 1 |
| ·19 | Handset bracket | 1 |
| ·18 | Aerator cap     | 1 |
| ·17 | Aerator         | 1 |
| ·16 | O ring          | 1 |
| ·15 | Spout           | 1 |
| ·14 | Collar          | 1 |
| ·13 | Washer          | 1 |
| ·12 | Brass nut       | 1 |
| ·11 | O ring          | 2 |
| ·10 | Body            | 1 |
| ·9  | Diverter cap    | 1 |
| ·8  | Handle          | 1 |
| ·7  | Chrome collar   | 1 |
| ·6  | Brass nut       | 1 |
| ·5  | Cartridge       | 1 |
| ·4  | Stand pipe      | 1 |
| ·3  | Base plate      | 1 |
| ·2  | Fixing anchor   | 1 |
| ·1  | Fixing bolt     | 3 |

| No. | Code | Name | Qty |
|-----|------|------|-----|
|-----|------|------|-----|