

SAGITTARIUS

TAPS & SHOWERING

ERGO LEVER TALL BASIN MONO MIXER EL/109/B

Construction	Brass Body, Zinc-alloy Handle
Finishes	Matt Black
Product Type	Contemporary
Water Pressure Tested Between Standards	Min. 0.2 bar, Max. 6.0 bar Complies with BS6920, BS EN200
Certification	WRAS approved
Cartridge	CITEC 35mm 110° Coolstart Ceramic disc cartridge
Aerator	Neoperl Slim Aerator
Fitting	UK: M10 x 350mm G½" BSP Female Flexi Tails EU: M10 x 350mm G3/8" BSP Female Flexi Tails
Guarantee	5 years against manufacturing faults (excluding serviceable parts)

Operating Water Pressure



COMBI BOILER
1.2 - 1.5+ bar



HIGH PRESSURE
1.2 - 1.5+ bar

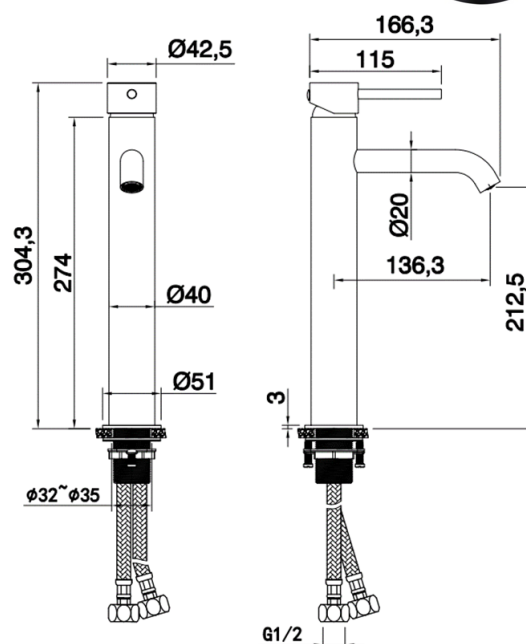

The information contained on this page was correct at the date of issue. Fitting dimensions are provided as a guide only. Some variation may occur due to manufacturing tolerances. We pursue a policy of continuing improvement in design and performance of our products and so reserve the right to change specifications without prior notice.

FOR FURTHER ADVICE PLEASE CONTACT :-

SAGITTARIUS LTD UNIT 1 LOWER VICTORIA STREET—CHADDERTON—OLDHAM—OL9 9TU TEL:0616 6202029

EMAIL:TECHNICAL@SAGITTARIUSTAPS.CO.UK

Flow Rates (Litres per minute)

System Pressure	0.1 Bar	0.2 Bar	0.3 Bar	0.5 Bar	1.0 Bar	1.5 Bar	2.0 Bar	3.0 Bar	4.0 Bar	5.0 Bar
	-	-	-	4.4	6.0	-	8.3	10.1	-	-

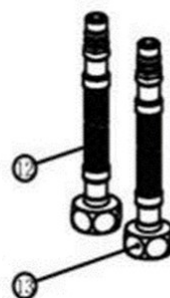
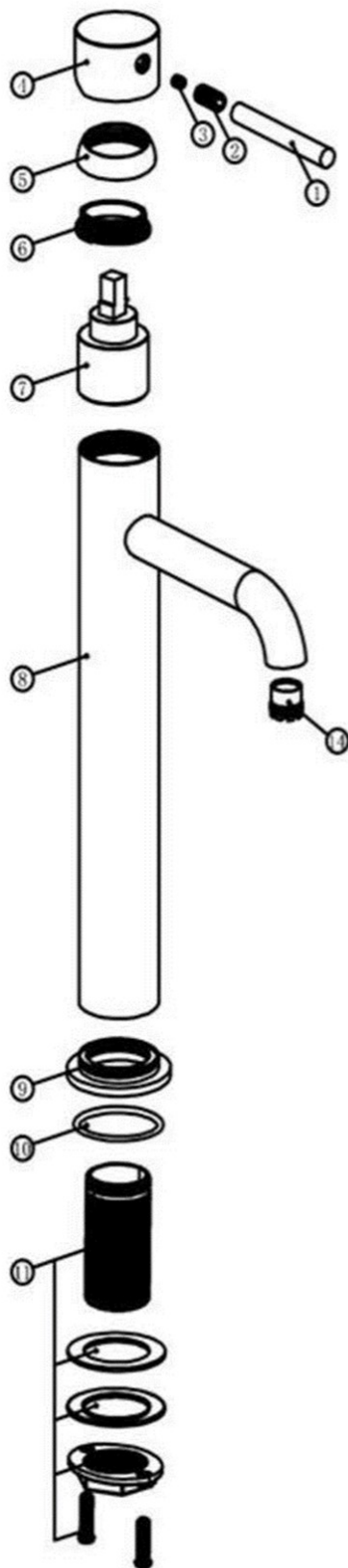

14	AERATOR	1	G08-18
13	HOSE (RED)	1	G08-17
12	HOSE (BLUE)	1	G08-16
11	SCREW	2	G08-15
11	BACKNUT	1	G08-14
11	WASHER	1	G08-13
11	WASHER	1	G08-12
11	BSP-TAIL	1	G08-11
10	O-RING	1	G08-10
9	BASE-PLATE	1	G08-09
8	BODY	1	G08-08
7	CARTRIDGE	1	G08-07
6	NUT	1	G08-06
5	SHROUD	1	G08-05
4	HANDLE	1	G08-04
3	SCREW	1	G08-03
2	SCREW	1	G08-02
1	LEVER	1	G08-01
NO.	NAME	QTY	CODE

FOR FURTHER ADVICE PLEASE CONTACT :-

SAGITTARIUS LTD UNIT 1 LOWER VICTORIA STREET—CHADDERTON—OLDHAM—OL9 9TU TEL:0616 6202029

EMAIL:TECHNICAL@SAGITTARIUSTAPS.CO.UK