

SAGITTARIUS

TAPS & SHOWERING

Construction Brass Body, Zinc-alloy & Ceramic Handles
Finishes Chrome plated
Water Pressure Tested Between Min. 0.5 bar (Handset) 1.5 bar (Shower Head), Max. 6.0 bar

Cartridge Thermostatic cartridge
Diverter Ceramic disc valve
Check Valve DN15
Fitting 15mm compression elbows
Guarantee 10 years against manufacturing faults (excluding serviceable parts)

Additional Information

Supplied with Shower Kits:
· Riser Rail : Chrome , telescopic adjustable height
· Shower head : Chrome , Traditional , Ø200mm
· Handset : Traditional , single mode , G1/2" BSP
· Handset holder , Chrome , Ceramic lever , adjustable height
· Shower hose : Chrome , Stainless steel , 1.5m , G1/2" BSP

EDWARDIAN THERMO VALVE AND RISER KIT WITH HANDSET ED/603

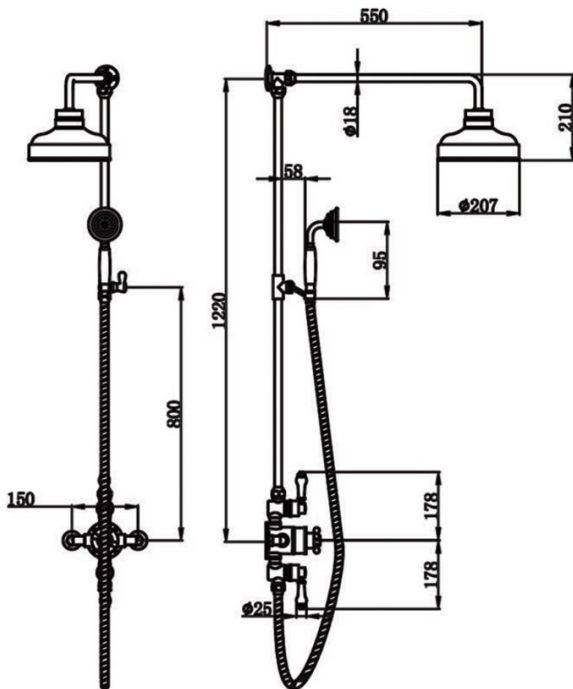

The information contained on this page was correct at the date of issue. Fitting dimensions are provided as a guide only. Some variation may occur due to manufacturing tolerances. We pursue a policy of continuing improvement in design and performance of our products and so reserve the right to change specifications without prior notice

FOR FURTHER ADVICE PLEASE CONTACT :-

SAGITTARIUS LTD UNIT 1 LOWER VICTORIA STREET—CHADDERTON—OLDHAM—OL9 9TU TEL:0616 6202029

EMAIL:TECHNICAL@SAGITTARIUSTAPS.CO.UK

Flow Rates (Litres per minute)

System Pressure	0.2 Bar	0.3 Bar	0.5 Bar	1.0 Bar	1.5 Bar	2.0 Bar	3.0 Bar	4.0 Bar	5.0 Bar
Handset	4.9	-	7.6	10.8	-	15.2	21.8	-	-
Shower Head	3.8	-	5.2	7.2	-	10.2	15.6	-	-

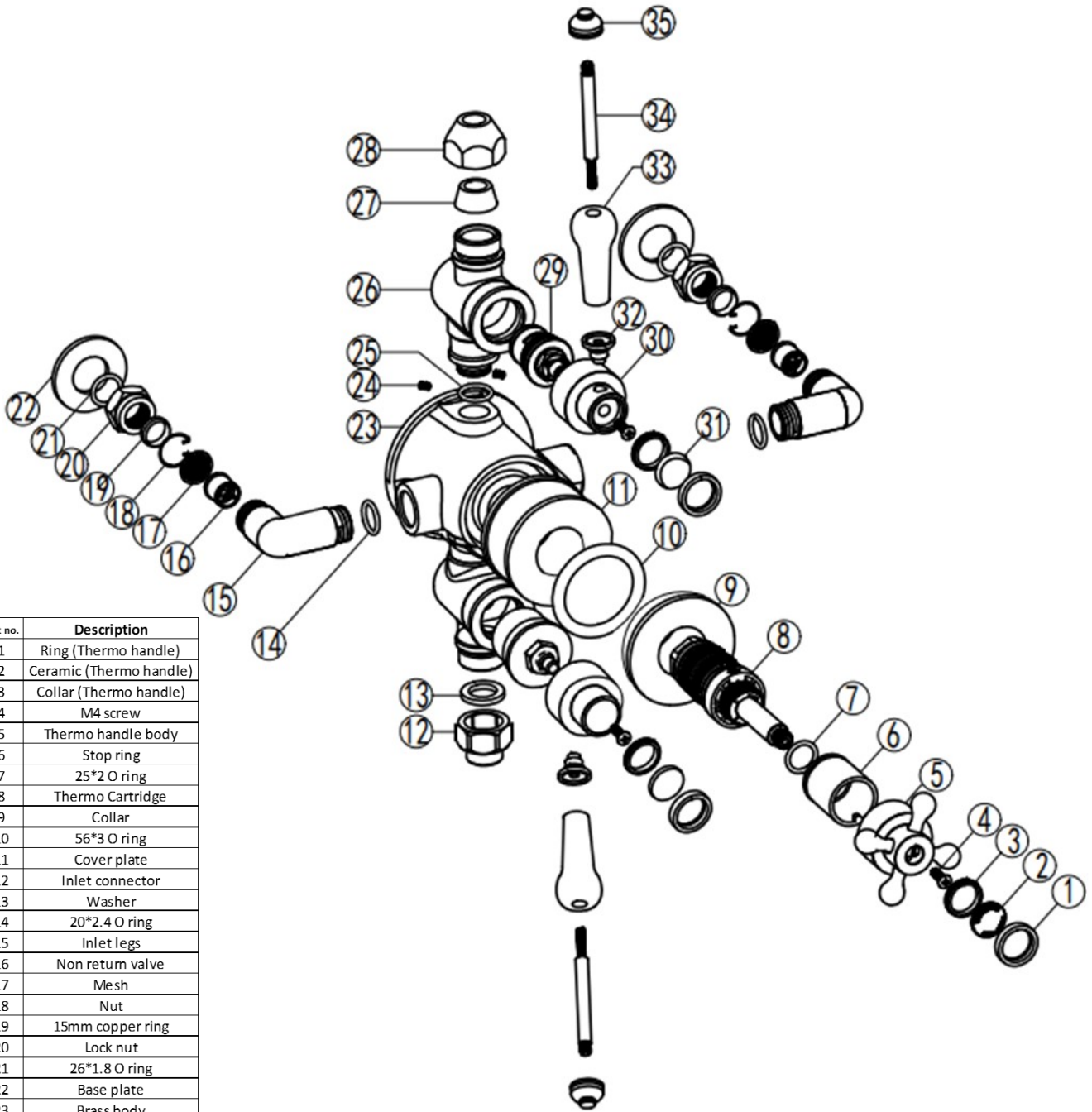

Part no.	Description
1	Ring (Thermo handle)
2	Ceramic (Thermo handle)
3	Collar (Thermo handle)
4	M4 screw
5	Thermo handle body
6	Stop ring
7	25*2 O ring
8	Thermo Cartridge
9	Collar
10	56*3 O ring
11	Cover plate
12	Inlet connector
13	Washer
14	20*2.4 O ring
15	Inlet legs
16	Non return valve
17	Mesh
18	Nut
19	15mm copper ring
20	Lock nut
21	26*1.8 O ring
22	Base plate
23	Brass body
24	M5 grub screw
25	19*1.9 O ring
26	On/off body
27	Washer
28	Lock nut
29	On/off Cartridge
30	On/off handle body
31	Indice (On/off handle)
32	On/off handle connector
33	Ceramic (On/off handle)
34	Rod (On/off handle)
35	Cover (On/off handle)

FOR FURTHER ADVICE PLEASE CONTACT :-
 SAGITTARIUS LTD UNIT 1 LOWER VICTORIA STREET—CHADDERTON—OLDHAM—OL9 9TU TEL:0616 6202029
 EMAIL:TECHNICAL@SAGITTARIUSTAPS.CO.UK