

SAGITTARIUS

TAPS & SHOWERING

Construction Brass Body (CuZn40Pb2), EN CW617N (equivalent to BS CZ122)
Zinc-alloy Handles

Finishes Chrome plated to BS EN 248

Product Type Contemporary

Water Pressure Min. 0.1 bar, Max. 6.0 bar

Tested Between

Standards Complies with BS6920, BS EN200

Cartridge 1/4 Turn 3/4" Ceramic disc valves

Aerator Spout aerator

Fitting M10 x 350mm G1/2" BSP Female Flexi Tails (UK)

Guarantee 10 years against manufacturing faults (excluding serviceable parts)

Additional Information Supplied with G1 1/4" sprung waste (UK only)

AVANT MONOBLOC BASIN MIXER & PUW CHROME

AV/106

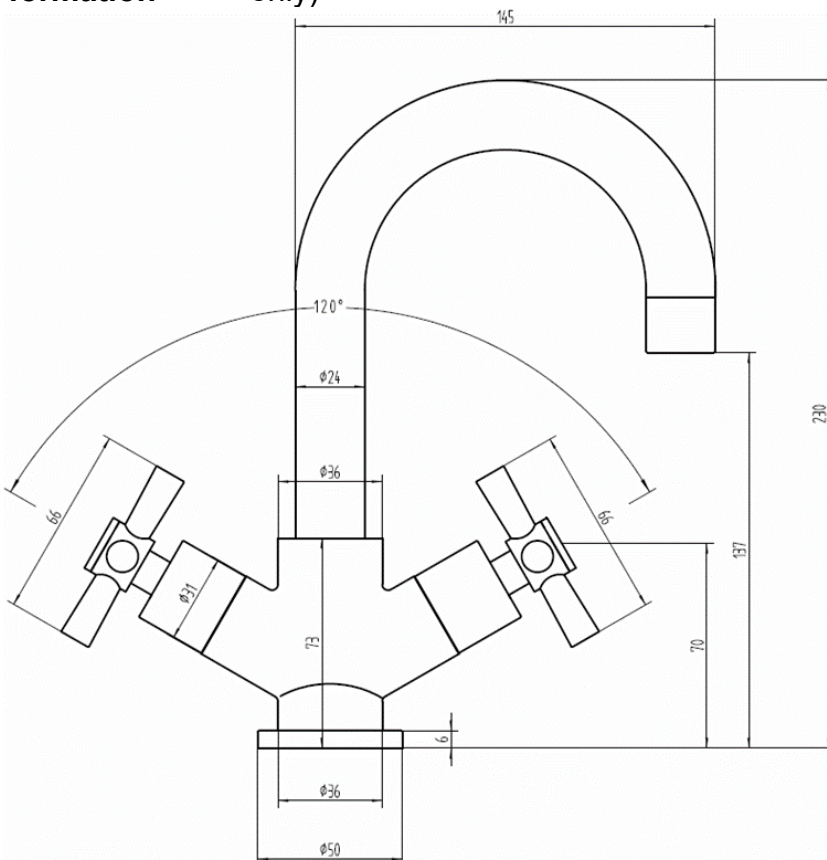

The information contained on this page was correct at the date of issue. Fitting dimensions are provided as a guide only. Some variation may occur due to manufacturing tolerances. We pursue a policy of continuing improvement in design and performance of our products and so reserve the right to change specifications without prior notice

FOR FURTHER ADVICE PLEASE CONTACT :-

SAGITTARIUS LTD UNIT 1 LOWER VICTORIA STREET—CHADDERTON—OLDHAM—OL9 9TU TEL:0616 6202029

EMAIL:TECHNICAL@SAGITTARIUSTAPS.CO.UK

Flow Rates (Litres per minute)

System Pressure	0.1 Bar	0.2 Bar	0.3 Bar	0.5 Bar	1.0 Bar	1.5 Bar	2.0 Bar	3.0 Bar	4.0 Bar	5.0 Bar
	3.0	4.1	-	5.0	7.0	9.0	13.1	15.0	-	-

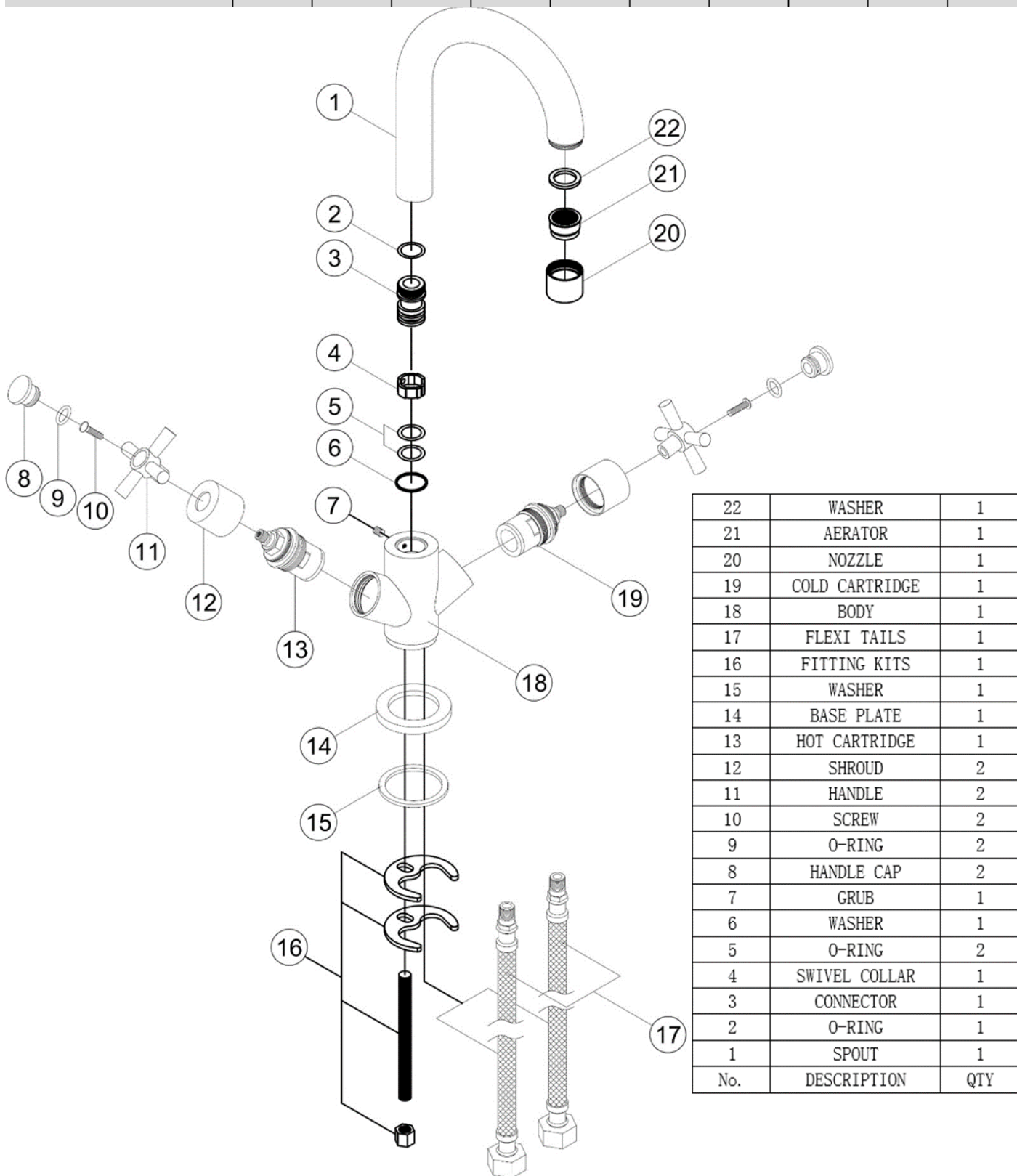

22	WASHER	1
21	AERATOR	1
20	NOZZLE	1
19	COLD CARTRIDGE	1
18	BODY	1
17	FLEXI TAILS	1
16	FITTING KITS	1
15	WASHER	1
14	BASE PLATE	1
13	HOT CARTRIDGE	1
12	SHROUD	2
11	HANDLE	2
10	SCREW	2
9	O-RING	2
8	HANDLE CAP	2
7	GRUB	1
6	WASHER	1
5	O-RING	2
4	SWIVEL COLLAR	1
3	CONNECTOR	1
2	O-RING	1
1	SPOUT	1
No.	DESCRIPTION	QTY

FOR FURTHER ADVICE PLEASE CONTACT :-

SAGITTARIUS LTD UNIT 1 LOWER VICTORIA STREET—CHADDERTON—OLDHAM—OL9 9TU TEL:0616 6202029

EMAIL:TECHNICAL@SAGITTARIUSTAPS.CO.UK